

Camino: CONSTRUCCIÓN DE LA CARRETERA SIN NOMBRE CON CONCRETO HIDRÁULICO DE EMILIO PORTES GIL - E.C.(SANTO TOMÁS OCOTEPEC - BENITO JUÁREZ), TRAMO DEL KM 0+000 AL KM 2+058, SUBTRAMO DEL KM 1+040 AL KM 2+058, EN EL MUNICIPIO DE SANTO TOMÁS OCOTEPEC.

PLANTA TOPOGRAFICA
DEL KM. 1+040.00 AL KM. 2+058.00

PROYECTO:

DIRECCION DE PROYECTOS Y CONTROL DE CALIDAD

REVISÓ:

			CAMINOS BIENESTAR		
JEFE DE LA UNIDAD DE ESTUDIOS Y PROYECTOS		DIRECTOR DE PROYECTOS Y CONTROL DE CALIDAD		EL DIRECTOR GENERAL	
Cecilia Profesional 1802384 ING. JAVIER RAMÍREZ REYES		Cecilia Profesional 1288000 ING. ALVARO PÉREZ HERNÁNDEZ		ING. MOISÉS SALAZAR MARTÍNEZ	

2025Escala 1:1000Plano 1 DE 1

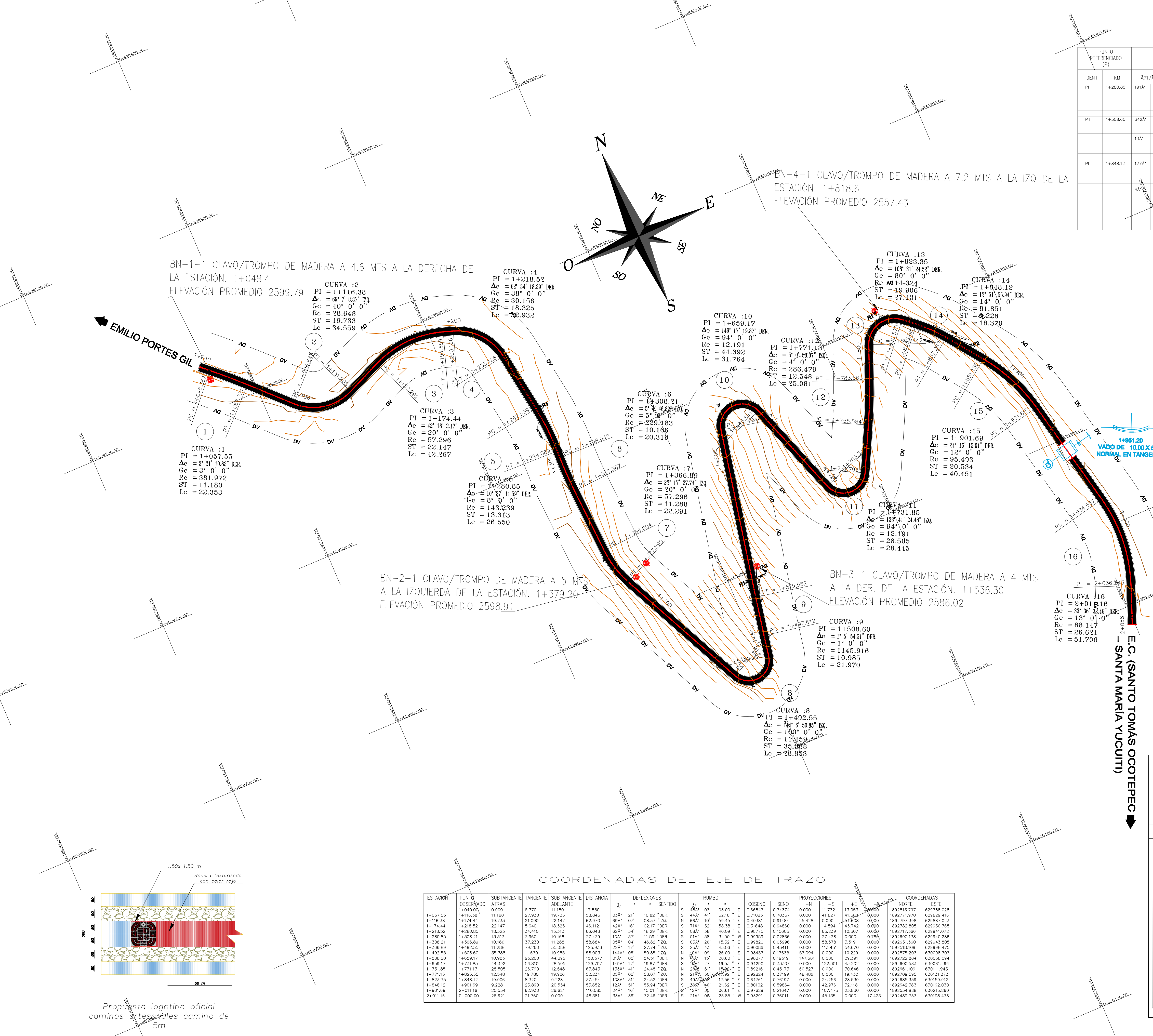

REFERENCIAS DEL TRAZO

ANGULOS (A1) SE MIDEN A LA DERECHA DESDE LA PROLONGACION DE LA TANGENTE DE ATRAS. LAS DISTANCIAS SON TOTALES													
DR1/DR3		COORDENADAS		DR2/DR4		COORDENADAS		GROUOS					
DIST	DESCRIPCION	N	E	DIST	DESCRIPCION	N	E						
013.45	CLAVO/TROMPO DE MADERA A 2.7 MTS A LA IZQ DEL KM 1+267.7	1892731.003	629941.743										

GEOMETRIA DEL ALINEAMIENTO HORIZONTAL

CURVA	T E O P E			N E C E			N P O P S T			N N E E			N E T O P T E		
	N	E	P	N	E	C	N	P	O	P	S	T	N	E	E
C1	1+040.00	1+040.00	1+040.00	1892825.529	629774.975	1+040.00	1892825.529	629774.975	1+040.00	1892825.529	629774.975	1+040.00	1892825.529	629774.975	1+040.00
C2	1892821.233	629779.710	1+040.00	1892821.233	629779.710	1+040.00	1892821.233	629779.710	1+040.00	1892821.233	629779.710	1+040.00	1892821.233	629779.710	1+040.00
C3	1892786.003	629815.530	1+040.00	1892786.003	629815.530	1+040.00	1892786.003	629815.530	1+040.00	1892786.003	629815.530	1+040.00	1892786.003	629815.530	1+040.00
C4	1892788.460	629866.754	1+040.00	1892788.460	629866.754	1+040.00	1892788.460	629866.754	1+040.00	1892788.460	629866.754	1+040.00	1892788.460	629866.754	1+040.00
C5	1892788.610	629913.370	1+040.00	1892788.610	629913.370	1+040.00	1892788.610	629913.370	1+040.00	1892788.610	629913.370	1+040.00	1892788.610	629913.370	1+040.00
C6	1892735.722	629938.583	1+040.00	1892735.722	629938.583	1+040.00	1892735.722	629938.583	1+040.00	1892735.722	629938.583	1+040.00	1892735.722	629938.583	1+040.00
C7	1892705.306	629940.565	1+040.00	1892705.306	629940.565	1+040.00	1892705.306	629940.565	1+040.00	1892705.306	629940.565	1+040.00	1892705.306	629940.565	1+040.00
C8	1892642.836	629943.117	1+040.00	1892642.836	629943.117	1+040.00	1892642.836	629943.117	1+040.00	1892642.836	629943.117	1+040.00	1892642.836	629943.117	1+040.00
C9	1892549.981	629983.104	1+040.00	1892549.981	629983.104	1+040.00	1892549.981	629983.104	1+040.00	1892549.981	629983.104	1+040.00	1892549.981	629983.104	1+040.00
C10	1892549.981	630006.757	1+040.00	1892549.981	630006.757	1+040.00	1892549.981	630006.757	1+040.00	1892549.981	630006.757	1+040.00	1892549.981	630006.757	1+040.00
C11	1892593.342	630029.420	1+040.00	1892593.342	630029.420	1+040.00	1892593.342	630029.420	1+040.00	1892593.342	630029.420	1+040.00	1892593.342	630029.420	1+040.00
C12	1892629.449	630071.781	1+040.00	1892629.449	630071.781	1+040.00	1892629.449	630071.781	1+040.00	1892629.449	630071.781	1+040.00	1892629.449	630071.781	1+040.00
C13	1892649.844	630106.264	1+040.00	1892649.844	630106.264	1+040.00	1892649.844	630106.264	1+040.00	1892649.844	630106.264	1+040.00	1892649.844	630106.264	1+040.00
C14	1892691.102	630123.957	1+040.00	1892691.102	630123.957	1+040.00	1892691.102	630123.957	1+040.00	1892691.102	630123.957	1+040.00	1892691.102	630123.957	1+040.00
C15	1892691.306	630152.866	1+040.00	1892691.306	630152.866	1+040.00	1892691.306	630152.866	1+040.00	1892691.306	630152.866	1+040.00	1892691.306	630152.866	1+040.00
C16	1892688.803	630179.722	1+040.00	1892688.803	630179.722	1+040.00	1892688.803	630179.722	1+040.00	1892688.803	630179.722	1+040.00	1892688.803	630179.722	1+040.00
C17	1892649.844	630201.082	1+040.00	1892649.844	630201.082	1+040.00	1892649.844	630201.082	1+040.00	1892649.844	630201.082	1+040.00	1892649.844	630201.082	1+040.00
C18	1892649.844	630201.082	1+040.00	1892649.844	630201.082	1+040.00	1892649.844	630201.082	1+040.00	1892649.844	630201.082	1+040.00	1892649.844	630201.082	1+040.00

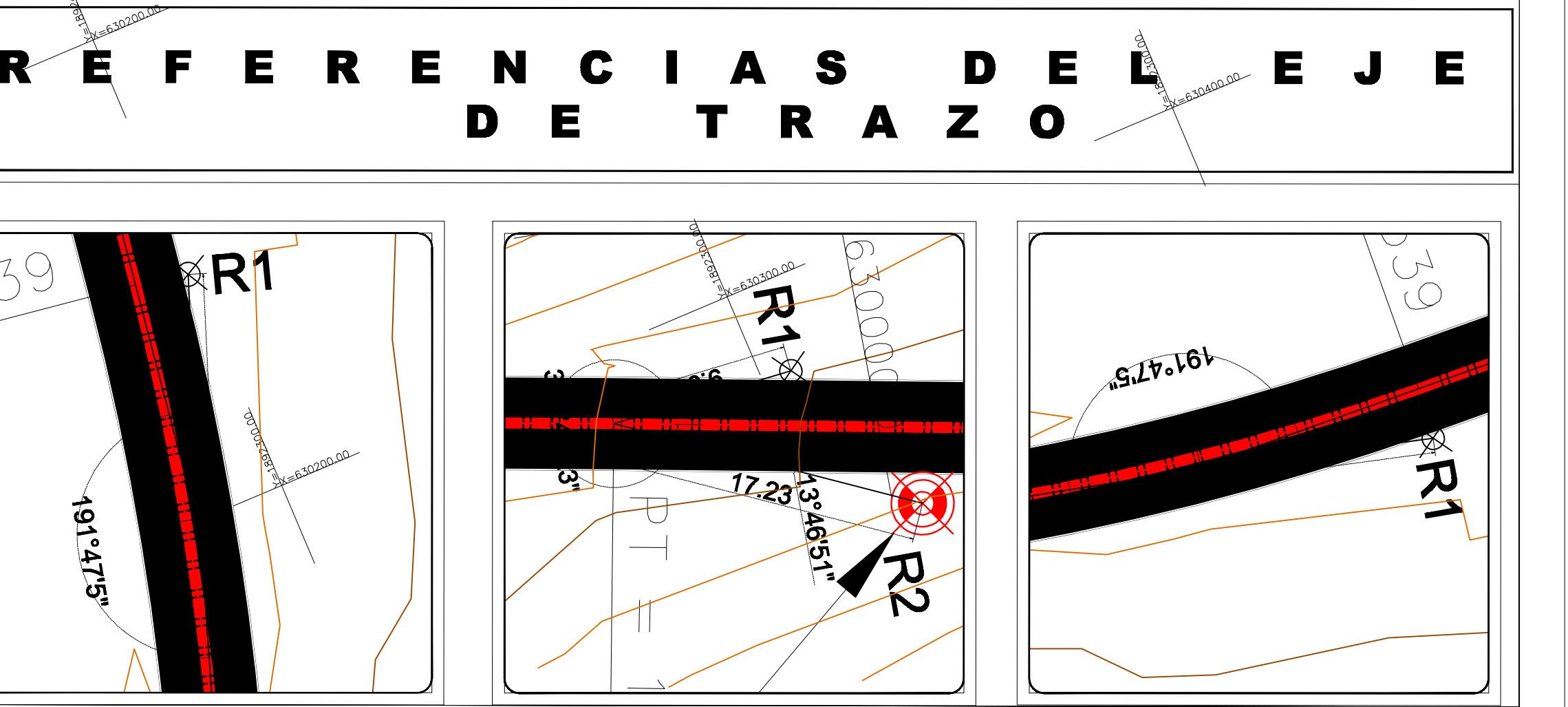

COORDENADAS DEL EJE DE TRAZO

ESTACION	PUNTO OBSERVADO	SUBTANGENTE ATRAS	TANGENTE ADELANTE	SUBTANGENTE ADELANTE	DISTANCIA	DEFLEXIONES		RUMBO	COSENO		SENO		PROYECCIONES		COORDENADAS	
						N	S		E	O	N	S	E	O		
1+040.00	1+040.00	0.000	6.370	11.180	17.550	0.00°	0.00°	S 48A° 01' 03.00" E	0.66847	0.74374	0.000	11.732	13.053	0.000	1892813.797	629788.028
1+057.50	1+118.96	11.180	19.733	29.147	38.843	0.00°	0.00°	S 44A° 41' 52.18" E	0.70883	0.70337	0.000	41.827	43.386	0.000	1892771.970	629829.416
1+116.38	1+174.44	19.733	29.147	38.843	69.970	0.00°	0.00°	S 66A° 10' 58.45" E	0.40281	0.91484	0.000	47.808	47.808	0.000	1892797.388	629887.023
1+174.44	1+218.52	29.147	38.843	48.112	46.112	0.00°	0.00°	S 71A° 32' 58.38" E	0.31648	0.94860	0.000	14.594	43.742	0.000	1892782.805	629930.765
1+218.52	1+260.85	38.843	48.112	57.249	69.970	0.00°	0.00°	S 68A° 58' 18.29" E	0.36471	0.92806	0.000	65.239	10.307	0.000	1892771.970	629941.072
1+260.85	1+308.21	48.112	57.249	66.044	10.166	0.00°	0.00°	S 01A° 38' 31.50" W	0.99959	0.02866	0.000	27.428	0.000	0.788	1892690.138	629940.286
1+308.21	1+356.59	57.249	66.044	73.235	11.288	0.00°	0.00°	S 03A° 26' 15.32" E	0.99920	0.05966	0.000	58.578	3.519	0.000	1892683.500	629943.805
1+356.59	1+402.55	66.044	73.235	79.260	35.388	0.00°	0.00°	S 25A° 43' 43.06" E	0.90086	0.43411	0.000	113.451	54.670	0.000	1892518.109	629998.475
1+402.55	1+450.60	73.235	82.399	82.399	10.985	0.00°	0.00°	N 00A° 09' 36.00" E	0.98433	0.17637	0.000	122.301	43.420	0.000	1892579.003	630008.703
1+450.60	1+498.60	82.399	91.464	91.464	44.392	0.00°	0.00°	N 03A° 15' 20.60" E	0.98077	0.19519	0.000	147.681	29.391	0.000	1892722.884	630038.094
1+498.60	1+546.60	91.464	100.533	100.533	28.505	0.00°	0.00°	N 08A° 27' 36.53" E	0.94290	0.33507	0.000	122.301	43.420	0.000	1892600.587	630081.705
1+546.60	1+594.60	100.533	109.602	109.602	15.228	0.00°	0.00°	N 15A° 15' 20.60" E	0.96926	0.45713	0.000	60.527	30.646	0.000	1892681.109	630101.943
1+594.60	1+642.60	109.602	118.671	118.671	19.906	0.00°	0.00°	N 20A° 51' 36.53" E	0.92924	0.37199	0.000	48.486	29.539	0.000	1892709.595	630131.373
1+642.60	1+690.60	118.671	127.740	127.740	24.544	0.00°	0.00°	N 28A° 51' 36.53" E	0.89276	0.45713	0.000	24.256	28.539	0.000	1892685.339	630159.912
1+690.60	1+738.60	127.740	136.809	136.809	29.344	0.00°	0.00°	N 35A° 41' 36.53" E	0.82072	0.59864	0.000	42.076	32.118	0.000	1892642.363	630192.030
1+738.60	1+786.60	136.809	145.878	145.878	34.140	0.00°	0.00°	N 42A° 15' 20.60" E	0.76729	0.64147	0.000	107.475	21.850	0.000	1892534.888	630215.860
1+786.60	1+834.60	145.878	154.947	154.947	38.936	0.00°	0.00°	N 50A° 15' 20.60" E	0.64761	0.76197	0.000	24.256	28.539	0.000	1892685.339	630159.912
1+834.60	1+882.60	154.947	164.016	164.016	43.732	0.00°	0.00°	N 58A° 15' 20.60" E	0.60702	0.59864	0.000	42.076	32.118	0.000	1892642.363	630192.030
1+882.60	1+930.60	164.016	173.085	173.085	48.528	0.00°	0.00°	N 66A° 15' 20.60" E	0.56741	0.59864	0.000	107.475	21.850	0.000	1892534.888	630215.860
1+930.60	1+978.60	173.085	182.154	182.154	53.324	0.00°	0.00°	N 74A° 15' 20.60" E	0.52801	0.59864	0.000	42.076	32.118	0.000	1892685.339	630159.912
1+978.60	2+000.00	182.154	191.223	191.223	58.120	0.00°	0.00°	N 82A° 15' 20.60" E	0.48901	0.59864	0.000	42.076	32.118	0.000	1892642.363	630192.030